

2303 SHIFT CABLE

YAMAHA F25C



Step 1: Route Cable

- Remove all components from the upper end of the Cable Assembly and run the cable between the Mid-Section and the Mounting Bracket.
- Re-Attach components.

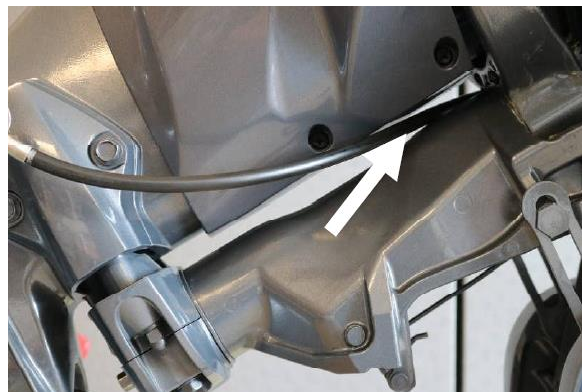

Step 2: Shift Handle Installation

- Set the factory shift handle into the neutral position and unscrew the M8 Bolt.
- Be sure to photograph the location and orientation of the bushings and washers inside the handle.
- Install modified shift handle with bushings and washers and tighten down the M8 Bolt.

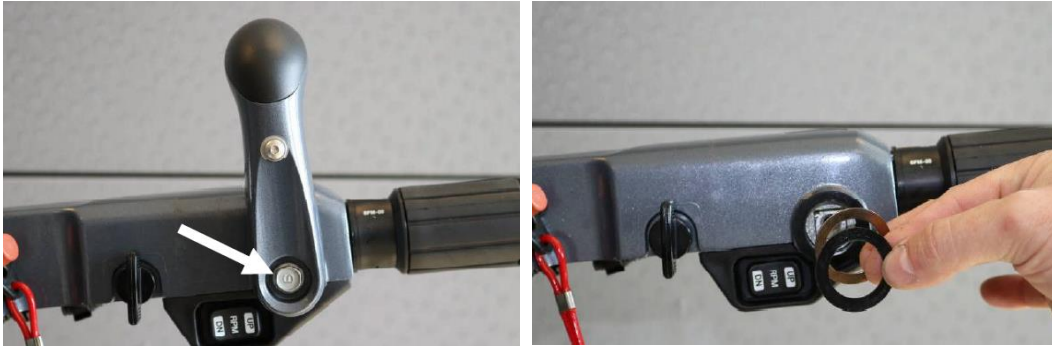

Step 3: Install Tiller Arm Bracket and upper Cable Support

- Unhook the Shift Cable from the upper support.
- Use pre-existing holes. If this is not an option, consult pages 27 and 28 of the BA-F25 Jet Kit Instructions.
- Tighten down all screws.
- Hook the Cable back into the upper support.

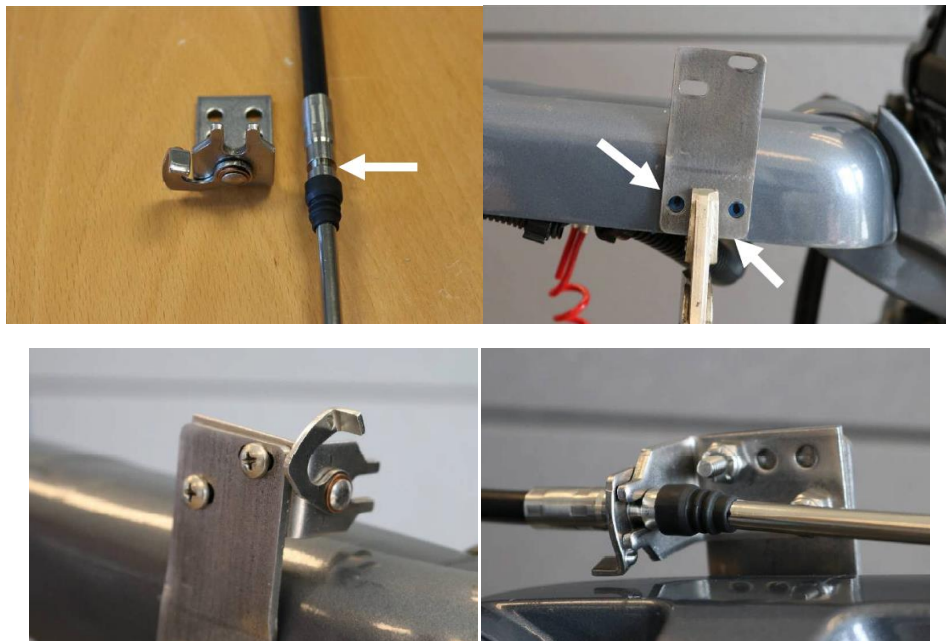

Step 4: Attach Lower End

- Bolt on the A-Frame Bracket.
- The Clamp attached to this bracket can pivot simply by loosening the screws. Once the correct position is set, tighten down the screws.
- Attach the Eyelet to the bolt on the Cam Bracket.
- Adjust as needed.

